

# TOWN OF GRAND COULEE

**Office:** 306-352-8694      **Fax:** 306-352-6659

**Maintenance:** 306-352-7086

**Email:** [grandcoulee.cap@sasktel.net](mailto:grandcoulee.cap@sasktel.net)  
[grandcouleemaintenance@sasktel.net](mailto:grandcouleemaintenance@sasktel.net)  
[grandcouleerecboard@gmail.com](mailto:grandcouleerecboard@gmail.com)

**Website:** [www.grandcoulee.ca](http://www.grandcoulee.ca)

**Facebook:** Town of Grand Coulee

---

## Highlights from November's council meeting

### Proposed Postal Code Change

Thank you to everyone who voiced their opinions regarding the proposed postal code change. The Town received over 40 responses, 55% of people were not in favour. Council passed a motion not to pursue, to keep the postal code the same.

### Bylaw Court

The RM of Edenwold has successfully established a bylaw court which the Town of Grand Coulee will be able to utilize. What this means is the Town is now able to enforce bylaw violations. The RM of Edenwold has been working with the Ministry of Justice for over 2 years to get this established. The Administrator will be meeting with the RM of Edenwold in the next month or so to figure out the details and costs that will be involved.

### Workshops

The Administrator will be attending an Asset Management workshop on November 28 and an OHS Class Training on December 6 & 7. The office will be closed for these days.

---

---



## Upcoming Events

### November 24

Movie Night at hall

### November 27 & Dec 22

Recycling Pick-up Dates

### December 2

Christmas Trade Show at SNS gym

### December 5

CP Rail Christmas Train

### December 11 @ 7:30 PM

Town Council Meeting

### Nov 28, Dec 6, 7, 25, 26 & January 1

Office closed

---

## TOWN OFFICE

**OFFICE HOURS – Monday, Tuesday, Wednesday and Friday 9AM to 4:00 PM; closed from noon to 1:00 PM**

**Thursday 9 AM to 5:00 PM; closed from noon to 1:00 PM**

**Mayor Botkin-** [mayor@grandcoulee.ca](mailto:mayor@grandcoulee.ca)

**Councillor Bouvier-**  
[joel@grandcoulee.ca](mailto:joel@grandcoulee.ca)

**Councillor Emery-**  
[Kenton@grandcoulee.ca](mailto:Kenton@grandcoulee.ca)

**Councillor Eveleigh-**  
[Tim@grandcoulee.ca](mailto:Tim@grandcoulee.ca)

**Councillor Kocur-**  
[Troy@grandcoulee.ca](mailto:Troy@grandcoulee.ca)

**Councillor Ridgway-**  
[Courtney@grandcoulee.ca](mailto:Courtney@grandcoulee.ca)

## MORE COMMUNITY NEWS

### Utility Arrears

Registered letters were sent out to residents with outstanding water bills. If arrears are not paid in full by December 21 they will be transferred to and form part of the property taxes.

### Tax Enforcement

Council authorized the Administrator to proceed with phase 2 of tax enforcement. Registered letters will be sent to the registered owners and all parties listed on the titles that have a registered interest.

### Outstanding 2018 Property Taxes

To avoid having another 1.50% interest added to your property taxes make payment to the office by November 30. 1.50% interest will be added on December 1 and **15%** will be added January 1.

### For Sale- John Deere Tractor w/ Snowblower

The Town is selling their John Deere 401A tractor with snowblower for \$2500 obo. Call Jim at 3065363097 for more information on the tractor.

### Water bills

Water readings will be done in Area 1 this month. Should you prefer to have actual reading each month, it is your responsibility as a homeowner to either **phone or email** your reading to us by the 29<sup>th</sup> of each month.

Below is a map of the Town that indicates which area you are in. At the end of November, actual readings will be taken in AREA 1

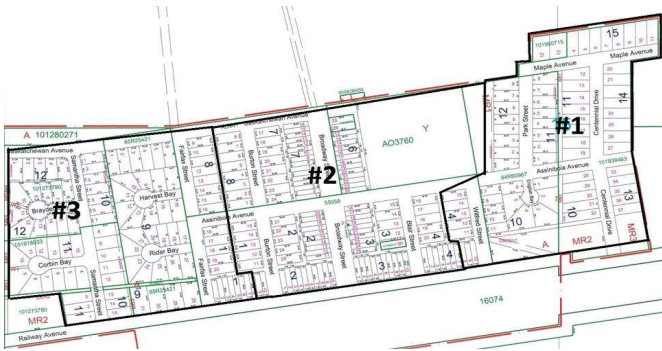

## In the Community

### Grand Coulee Story Time

Story time happens every Thursday at 9:30am. For more information go to their facebook page @grandcouleestorytime

### GRAND COULEE EMERGENCY SERVICES

Grand Coulee Emergency Services consist of volunteer first responders and the volunteer fire department. If you are interested in joining either or both, please contact Brian at [emergencyservicesgc@gmail.com](mailto:emergencyservicesgc@gmail.com)

